



KONICA MINOLTA

INCREASED PRODUCTIVITY

A3 Monochrome bizhub 306 Series



bizhub 306/266

Giving Shape to Ideas

HIGH QUALITY MONOCHROME MFP WITH ENHANCED FEATURES

> Ease of Connectivity

PageScope Mobile support

PageScope Mobile (PSM) is a Konica Minolta genuine app made for mobile devices such as smartphones and tablets. The app enables printing to Konica Minolta MFPs from mobile devices and allows uploading of scanned data using Konica Minolta MFPs to mobile devices.

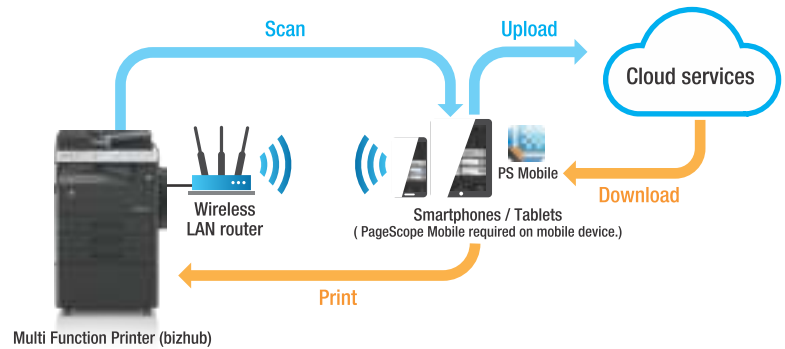

> Enhanced Network Connectivity

Standard network connectivity and wireless options

The bizhub 306/266 is equipped with NIC (Network Interface Card) as standard. If the Wireless LAN Kit UK-213 (optional) is attached, users can print to MFP without a LAN cable connection. A wireless LAN router is required to use this function.

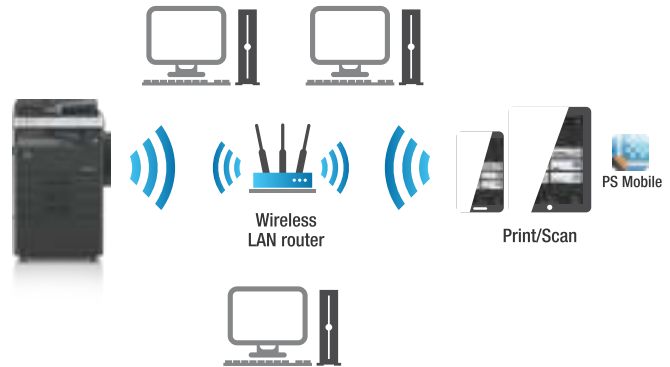

> Ease of Use



Option Panel (MK-750)

MK-750 is required with the installation of Fax Kit FK-510.

ID COPY

The "ID Copy" button can instantly perform ID copy function.

High-resolution backlit LCD screen

With a five-line display screen, the backlit display screen is clearly visible even in dark places.

LCD display language support

There are 26 languages available for selection.

* Thai and Vietnamese language are available with special firmware.

Superior accessibility

Basic functions such as Print, Scan and Copy are placed near to each other to improve user experience.

> Convenient Print & Scan Features

USB direct print & scan

Connect USB memory to directly print data from the memory, or save scanned data to the USB memory.

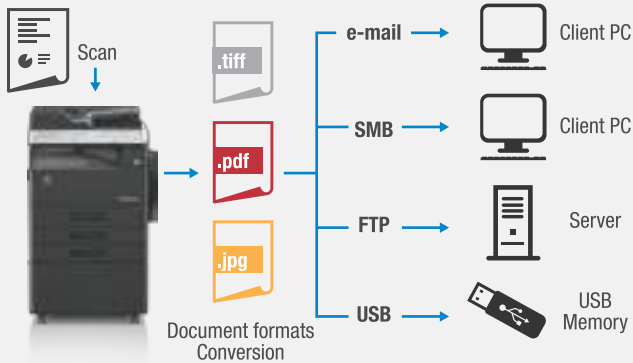

> Multiple destination

The scanned files can be saved directly to USB memory, or sent to different destination such as e-mail, SMB or FTP. The supported scan formats are TIFF, PDF and JPEG.

> Linux Support

Users can print from Linux OS to bizhub 306 series.

> Variety of copy and print features

Outer Erase

When this feature is on, the area of the original document is detected by the MFP, the shadow area will be trimmed automatically. This feature is useful when copying a thick book and not able to fully close the ADF.

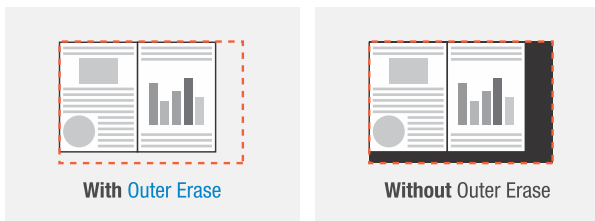

ID Copy

Using the ID copy function, contents of the front and back sides of a card, for example, driver's license or business card, can be combined into one sheet.

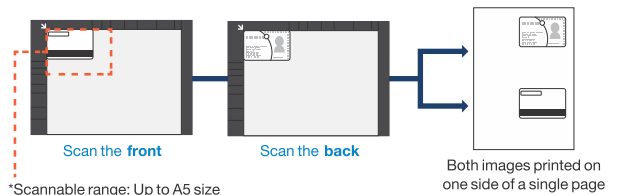

N-up Print (2in1, 4in1)

Multi-page documents can be printed on one sheet. 2in1 prints 2 pages on 1 sheet, and 4in1 prints 4 pages on 1 sheet.

* 32-in-1 when printing

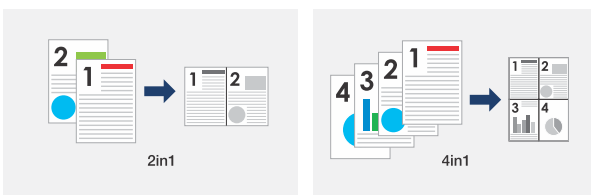

Duplex Print or Copy

Equipped with an Auto Duplex Unit as standard. This enables double-sided printing, helping to save paper. Also, Reverse Automatic Document Feeder (DF-625) can be added as an option. This enables duplex scan, to increase user's work efficiency.



ADVANCED SECURITY FEATURES TO PROTECT VALUABLE INFORMATION

> SMTP authentication

For companies without e-mail servers

To support SMTP authentication which permits sending e-mail to users authenticated by the SMTP server. E-mail servers and ISPs (Internet Service Providers) etc which are set for SMTP authentication can be used. Connection to an SMTP server allows SSL communication, so e-mail can be sent in a security-conscious state. This is suitable for small offices and other situations without a private e-mail server.

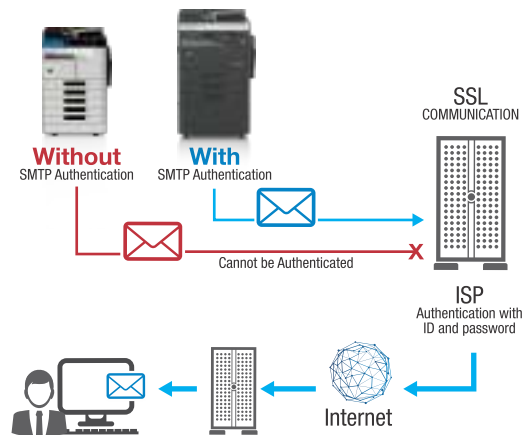

> Security Print

To manage print with password

Even when a print job is executed, the MFP will not print until password has been entered.

Password Input screen

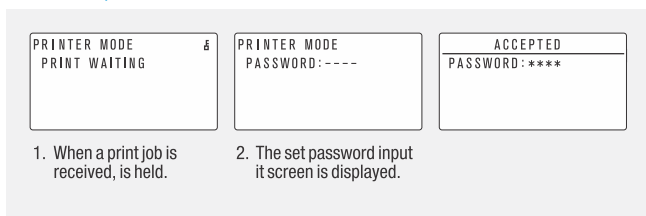

> Watermark

Manage confidential documents

Different types of Watermarks can be added on the documents based on the purpose or importance level of documents.



> Account Track

For better user management

Usage restrictions can be applied to copy and print functions by registering a 3-digit account number. This restricts users who are not authorised to use the MFP, and usage by each account can be tracked.



bizhub 306/266



PRINT SPEED:
30 / 26 ppm
Monochrome

MAX POWER CONSUMPTION: **1300w**

MAX PAPER CAPACITY: **1,350**^{*1} sheets
*1 With options attached.

SCANNING SPEED^{*2}:
26 / 46 opm
Colour / Monochrome

*2 When using the Reverse Automatic Document Feeder DF-625.

SCAN RESOLUTION:
up to
600x600 dpi

PRINT RESOLUTION:
600x600 dpi

Key Features:

Booklet print to collate multiple pages into one booklet and variety of duplex copy methods to fulfil different purposes.

To output 2-sided document into one sheet. Example: ID Copy.

Multiple convenient colour scan features.



Simitri
with Biomass

^{*1} Optional
^{*2} 150 dpi
^{*3} 300 dpi

SYSTEM - bizhub 306 / 266

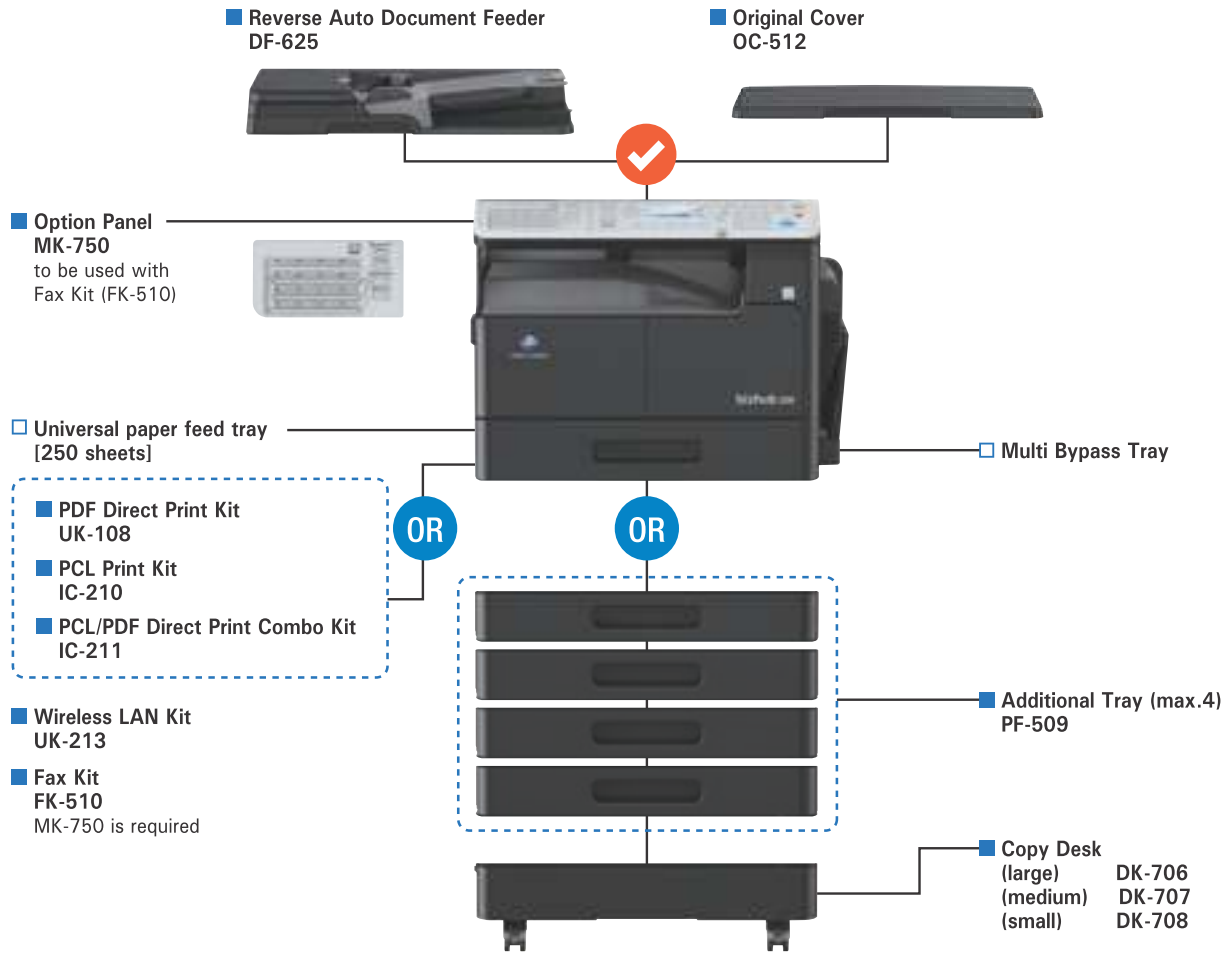

Note: Some options are not listed.

OR One of the options may be selected (not mandatory).

✓ One of the options must be selected (mandatory).

■ Optional
□ Standard

*1 DK-706 use with max 1 additional tray
*2 DK-707 use with max 2 additional tray
*3 DK-708 use with max 4 additional tray

SPACE REQUIREMENTS - bizhub 306 / 266

Dimensions (unit: mm)

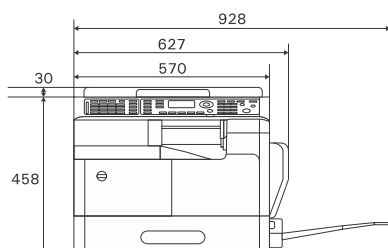

Front View
bizhub 306/266 + OC-512

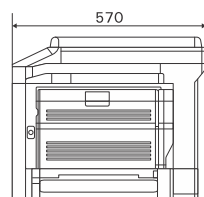

Side View

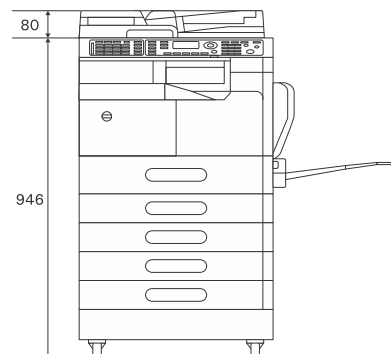

Front View
bizhub 306/266 + DF-625 + PF-509 x4 + DK-708

Basic Functions and Copy Functions

Type	Desktop	
Colour availability	B/W	
Reading resolution	600 dpi x 600 dpi	
Writing resolution	600 dpi x 600 dpi	
Gradation	256 levels	
Memory size	512 MB (standard)	
Original type	Sheet, book, three-dimensional objects (max. 2 kg)	
Max. original size	A3 or Ledger (11" x 17")	
Copy size	Metric: A3 - A5 Inch: Ledger (11" x 17") - Invoice (5.5" x 8.5")	
Input paper capacity	STD: 1 tray	Plain paper/Recycle paper: 250 sheets Thick paper: 20 sheets Envelopes: 10 sheets OHP: 10 sheets
Additional paper tray	Max: 4 trays	Plain paper/Recycle paper: 250 sheets
	Multi bypass tray	Plain paper/Recycle paper: 100 sheets Thick paper: 20 sheets Envelopes: 10 sheets OHP: 10 sheets
Image chipping width	4 mm at each edge (top/bottom/right/left edge)	
Warm-up time (73.4°F (23°C), std. Voltage)	within 15 sec.	
First copy time	within 5 sec.* * A4 long edge feed full size/using the first tray/scanning from the original glass surface.	
Copy speed	A4 landscape, B5 portrait	306 : 30 sheets/min. 266 : 26 sheets/min.
	B4	306 : 12 sheets/min. 266 : 12 sheets/min.
	A3	306 : 11 sheets/min. 266 : 11 sheets/min.
Copy magnification	Fixed ratio	Metric 0.25/0.50/0.70/0.81/1.00 /1.15/1.41/2.00/4.00
		Inch 0.25/0.50/0.64/0.78/1.00 /1.21/1.29/2.00/4.00
	Zoom ratio set by Up/Down key	25% to 400% Adjustable in 0.01 steps
Paper handling/paper capacity (64 g/m ²)	Main unit: Universal cassette, 250 sheets x 5 + Multi-bypass tray: 100 sheets	
Supported paper weight	Main body/Bypass tray	64 g/m ² - 157 g/m ²
	Additional paper tray	64 g/m ² - 90 g/m ²
Multi copy setting	1-999 pages	
Max power consumption	1.55 kW or less	
Dimensions [W] x [D] x [H]	627 x 570 x 488* mm * To the face of platen glass 627 x 570 x 488** mm ** To the top of original cover	
Weight	Approx. 30.8 kg (excluding TC/Developer)	
Space requirements [W] x [D]	Standard configuration: 570 x 570 mm With bypass tray: 928 x 570 mm Max required space incl. maintenance space: 999 x 971 mm	
Application software	PageScope Net Care Device Manager & Plug-in LSU(Local Setting Utility) PageScope Mobile (Scan, Print)	

Printer Functions (Standard: GDI Image Controller)

Type	Embedded	
Print Speed	A4	306 : 30 ppm 266 : 26 ppm
	Letter	306 : 30 ppm 266 : 26 ppm
Resolution	600 dpi x 600 dpi	
Supported OS	Server	Windows Server 2008** / 2008 R2 (x64) / 2012 (x64) / 2012 R2 (x64) * Supports the 32-bit (x86) or 64-bit (x64) environment.
	Client	Windows Vista** / 7** / 8.1** / 10** * Supports the 32-bit (x86) or 64-bit (x64) environment. Red Hat Enterprise Linux 5 (CUPS Ver1.2.4) x86 Red Hat Enterprise Linux 5 (CUPS Ver1.2.4) AMD64/Intel64 SUSE Linux Enterprise Desktop 11(CUPS Ver1.1.23) x86 SUSE Linux Enterprise Desktop 11(CUPS Ver1.1.23) AMD64/Intel64
Interface	Standard: USB2.0 Ethernet 10Base-T/100Base-TX	
Supported protocols	TCP/IP	

Printer Functions (Optional: PCL Controller)

Type	PCL Print Kit, IC-210 or PCL / PDF Direct Print Combo Kit, IC-211	
Print Speed	A4	306 : 30 ppm 266 : 26 ppm
	Letter	306 : 30 ppm 266 : 26 ppm
Resolution	1,200 dpi or 600 dpi x 600 dpi	
Page description language	PCL6/5e	
Supported OS	Server	Windows Server 2008** / 2008 R2 (x64) / 2012 (x64) / 2012 R2 (x64) * Supports the 32-bit (x86) or 64-bit (x64) environment.
	Client	Windows Vista** / 7** / 8.1** / 10** * Supports the 32-bit (x86) or 64-bit (x64) environment. Red Hat Enterprise Linux 5 (CUPS Ver1.2.4) x86 Red Hat Enterprise Linux 5 (CUPS Ver1.2.4) AMD64/Intel64 SUSE Linux Enterprise Desktop 11(CUPS Ver1.1.23) x86 SUSE Linux Enterprise Desktop 11(CUPS Ver1.1.23) AMD64/Intel64
Interface	Standard: USB2.0 Ethernet 10Base-T/100Base-TX, IEEE 802.11	
Supported protocols	TCP/IP	

Scanner Functions

Type	Full colour scanner	
Supported size	Standard: Max. A3 or Ledger (11" x 17") DF-625 (Option ADF): Max. A3 or Ledger (11" x 17")	
Interface	Ethernet 10Base-T/100Base-TX USB2.0 (Standard) USB2.0 Host	
Scan function	TWAIN/WIA: Real time mode(full), Scan to USB memory Network scan: Scan to FTP, Scan to PC (SMB), Scan to e-mail, Network TWAIN, Scan to PageScope Mobile	
Driver	TWAIN/WIA driver	
Data format	TIFF, JPEG, PDF	

Fax Functions (Optional)

* Option panel MK-750 is required.

Fax Kit	FK-510	
Transmission standard /Communication mode	G3	
Transmission speed	2.4 kbps - 33.6 kbps	
Data compression	MH, MR, MMR, JBIG	
Transmission time	Approx. 3 sec. (A4, V.34, 33.6 kbps, JBIG)	
Transmission size	Scanner: Max. A3 Option DF-625: Max. (W x L) 297 x 1,000 mm	
Recording size	Max. A3 (Max 1,000 mm, printed according to page pagination)	
Line density	8 dot/mm x 3.85 line/mm, 8 dot/mm x 7.7 line/mm, 8 dot/mm x 15.4 line/mm, 16 dot/mm x 15.4 line/mm	
Number of Abbreviated.Dial	250	
Number of One.Touch.Dial	32	
Number of Program dials	4	
Sequential multiple station transmission	Max. 255	
Driver	PC-FAX driver	

Reverse Auto Document Feeder (Optional)

Applied models	DF-625	
Document feeder type	Circulatory duplex system	
Original type	Plain paper, 35 to 128 g/m ² (Simplex), 50 to 128 g/m ² (Duplex, Mixed Original)	
Original size	Max. A3 or Ledger (11" x 17") (Fax mode: Max. 1,000 mm)	
Original loading capacity	70 sheets (80 g/m ²) Supports mixed originals in the same and different series.	
Feeding speed (A4 portrait, Simplex) *At copying	Colour: 26 opm (150 dpi), 8 opm (300 dpi) B/W: 46 opm (150 dpi, 300 dpi), 23 opm (600 dpi)	
Power supply	Supplied from the main unit.	
Dimensions [W] x [D] x [H]	546 x 486 x 80 mm	
Weight	5.3 kg	





PT . PERDANA JATIPUTRA

Jl. Bungur Besar No. 89 Jakarta 10620 , Indonesia
Sales : (021) 424 8809 (Hunting), Service (021) 420 3888 (Hunting)
Fax : (021) 424 1581/420 1239
E - mail : marketing@perdana.biz
Website : www.perdana.biz

CABANG & DEPO

Bekasi :

Jl. M.H. Thamrin Ruko Plaza Menteng, Blok B No. 7
Lippo Cikarang, Phone : (021) 899 05257

Bogor :

Jl. Kd Halang Ruko 2B, Warung Jambu
Bogor, Phone : (0251) 831 6366

Bandung :

Jl. Batununggal Indah IV, No. 29, Bandung
Phone : (022) 751 0509

Tangerang :

Kompleks Duta Mas Plaza Blok F/17
Taman Cibodas, Jl. Gatot Subroto KM 3,5
Cimone, Tangerang, Phone : (021) 552 7959

Medan :

Jl. Raden Saleh No. 75 - 77, Medan
Phone : (061) 451 8552

Makasar :

Jl. Danau Tanjung Bunga Utara No. 109
Taman Kahyangan, Tanjung Bunga
Phone : (0411) 839 353

Manado :

Jl. Arie Lasut, Perum Kombos Holy Lestari Blok B No. 1
Phone : (0431) 877 4773



› Environmental certification

The Blue Angel compliance
bizhub 306 Series meets the criteria of
current Blue Angel (RAL-UZ171) certification.



CertNo:
12 310 50050TMS
ISO/IEC 27001:2013



CertNo: 2015-2-2299
ISO 9001: 2008
CertNo: 2015-06-38
ISO 14001: 2004

Hubungi Kami :



FOR THE EARTH. FOR THE FUTURE.

